

SPRING CHECK VALVES



Spring Check Valve

Features

- Spring type
- Material: SS316
- Seat: Metal/Viton
- Size: 1/4" – 2"
- Working Pressure: 1000 PSI
- Threaded End: BSPP, NPT
- Cracking Pressure: 1 Bar
- Applicable Medium: General oil, Gas & Water applications
- Temperature Range: -29°C to 150°C



Spring Check Valve with Metal Seat

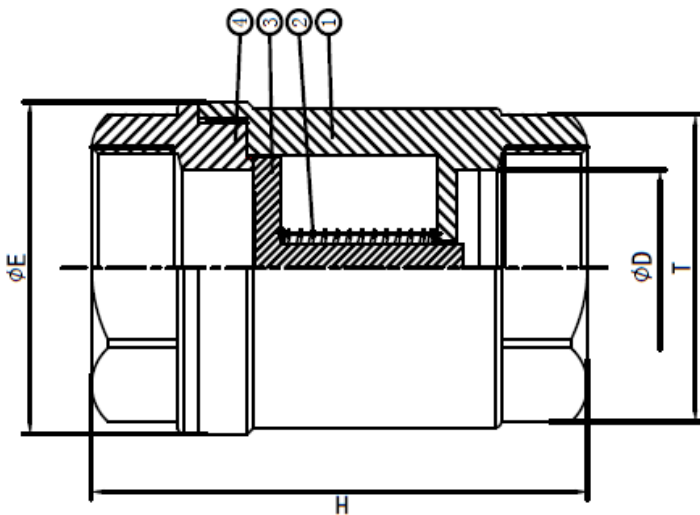

Material List

No.	Part Name	Material
1	Body	SS316, CF8M
2	Spring	SS316
3	Disc	SS316, CF8M
4	Cap	SS316, CF8M

Spring Check Valve with Viton Seat

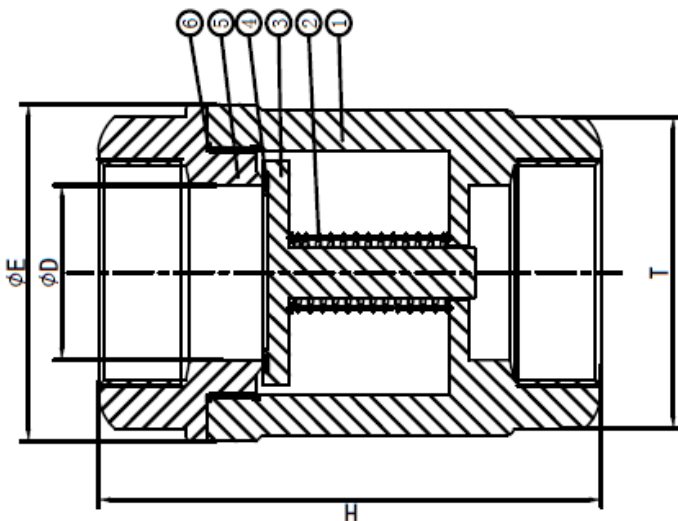

Material List

No.	Part Name	Material
1	Body	SS316, CF8M
2	Spring	SS316
3	Disc	SS316, CF8M
4	Seat Ring - (O-Ring)	VITON
5	Cap	SS316, CF8M
6	Seal Gasket	PTFE

Ordering Information

VL - S - B2 - G - 1000 - 08
 I II III IV V VI

I Type of Item

VL Low Pressure Valves

II Material Grade

S	SS316, CF8M	CI	Cast Iron
FS	Forged Steel	CS	Cast Steel
B	Brass		

III Item

GA	Gate Valve	B1	1 PC Ball Valve
GL	Globe Valve	B2	2 PC Ball Valve
YS	Y-Strainer	B3	3 PC Ball Valve
SC	Swing Check Valve	BL	3 Way Ball Valve L Port
VC	Vertical Check Valve	BT	3 Way Ball Valve T Port
WC	Wafer Check Valve	BMF	Male x Female Mini Ball Valve
DD	Dual Disk	BU	Butterfly Valve

IV Connection Type

SW	S/W	G	BSPP
BW	B/W	N	NPT
R	BSPT	F	Flanged End
W	Wafer	L	Lug

V Pressure

200	200 PSI	1000	1000 PSI
300	300 PSI	150	ANSI 150# Flange Standard
600	600 PSI	10K	JIS 10K Flange Standard
800	800 PSI	PN16	PN16 Flange Standard

For Inch OD & Inch NB Sizes
VI Size

Size	1/8"	1/4"	5/16"	3/8"	1/2"	5/8"	3/4"	1"
Code	02	04	05	06	08	10	12	16
Size	1 1/4"	1 1/2"	2"	2 1/2"	3"	4"	5"	6"
Code	20	24	32	40	48	64	80	96

VII Coating

(none) No additional Coating
 NI Nickel Plating

Dimension List

NPS	Connection	Impa Code	Part No	D	H	E	T	Weight (kg)
1/2"	BSPP	-	VL-S-VC-G-1000-08	14	62	39	27	0.25
			VL-S-VC-G-VI-1000-08					
3/4"	BSPP	-	VL-S-VC-G-1000-12	19	69	43	32	0.36
			VL-S-VC-G-VI-1000-12					
1"	BSPP	-	VL-S-VC-G-1000-16	24	82	48	38	0.48
			VL-S-VC-G-VI-1000-16					
1 1/4"	BSPP	-	VL-S-VC-G-1000-20	30	93	58	47	0.85
			VL-S-VC-G-VI-1000-20					
1 1/2"	BSPP	-	VL-S-VC-G-1000-24	38	102	71	55	1.32
			VL-S-VC-G-VI-1000-24					
2"	BSPP	-	VL-S-VC-G-1000-32	48	116	81	68	1.88
			VL-S-VC-G-VI-1000-32					
3"	BSPP	-	VL-S-VC-G-1000-48	78	170	140	98	-
			VL-S-VC-G-VI-1000-48					
1/2"	NPT	-	VL-S-VC-N-1000-08	14	62	39	27	0.25
			VL-S-VC-N-VI-1000-08					
3/4"	NPT	-	VL-S-VC-N-1000-12	19	69	43	32	0.36
			VL-S-VC-N-VI-1000-12					
1"	NPT	-	VL-S-VC-N-1000-16	24	82	48	38	0.48
			VL-S-VC-N-VI-1000-16					
1 1/4"	NPT	-	VL-S-VC-N-1000-20	30	93	58	47	0.85
			VL-S-VC-N-VI-1000-20					
1 1/2"	NPT	-	VL-S-VC-N-1000-24	38	102	71	55	1.32
			VL-S-VC-N-VI-1000-24					
2"	NPT	-	VL-S-VC-N-1000-32	48	116	81	68	1.88
			VL-S-VC-N-VI-1000-32					
3"	NPT	-	VL-S-VC-N-1000-48	78	170	140	98	-
			VL-S-VC-N-VI-1000-48					

Spring Check Valve with Metal Seat Part Number Reference

Impa Code	Part No	Description
-	VL-S-VC-G-1000-04	1/4"BSPP SS316 SPRING CHECK VALVE 1000 PSI,CRACKING PRESSURE:1 BAR,METAL SEAT
-	VL-S-VC-G-1000-06	3/8"BSPP SS316 SPRING CHECK VALVE 1000 PSI,CRACKING PRESSURE:1 BAR,METAL SEAT
-	VL-S-VC-G-1000-08	1/2"BSPP SS316 SPRING CHECK VALVE (1000 PSI,CRACKING PRESSURE:1 BAR,METAL SEAT
-	VL-S-VC-G-1000-12	3/4"BSPP SS316 SPRING CHECK VALVE 1000 PSI,CRACKING PRESSURE:1 BAR,METAL SEAT
-	VL-S-VC-G-1000-16	1"BSPP SS316 SPRING CHECK VALVE 1000 PSI,CRACKING PRESSURE:1 BAR,METAL SEAT
-	VL-S-VC-G-1000-20	1 1/4"BSPP SS316 SPRING CHECK VALVE 1000 PSI,CRACKING PRESSURE:1 BAR,METAL SEAT
-	VL-S-VC-G-1000-24	1 1/2"BSPP SS316 SPRING CHECK VALVE 1000 PSI,CRACKING PRESSURE:1 BAR,METAL SEAT
-	VL-S-VC-G-1000-32	2"BSPP SS316 SPRING CHECK VALVE 1000 PSI,CRACKING PRESSURE:1 BAR,METAL SEAT
-	VL-S-VC-N-1000-04	1/4"NPT SS316 SPRING CHECK VALVE 1000 PSI,CRACKING PRESSURE:1 BAR,METAL SEAT
-	VL-S-VC-N-1000-06	3/8"NPT SS316 SPRING CHECK VALVE 1000 PSI,CRACKING PRESSURE:1 BAR,METAL SEAT
-	VL-S-VC-N-1000-08	1/2"NPT SS316 SPRING CHECK VALVE 1000 PSI,CRACKING PRESSURE:1 BAR,METAL SEAT
-	VL-S-VC-N-1000-12	3/4"NPT SS316 SPRING CHECK VALVE 1000 PSI,CRACKING PRESSURE:1 BAR,METAL SEAT
-	VL-S-VC-N-1000-16	1"NPT SS316 SPRING CHECK VALVE 1000 PSI,CRACKING PRESSURE:1 BAR,METAL SEAT
-	VL-S-VC-N-1000-20	1 1/4"NPT SS316 SPRING CHECK VALVE 1000 PSI,CRACKING PRESSURE:1 BAR,METAL SEAT
-	VL-S-VC-N-1000-24	1 1/2"NPT SS316 SPRING CHECK VALVE 1000 PSI,CRACKING PRESSURE:1 BAR,METAL SEAT
-	VL-S-VC-N-1000-32	2"NPT SS316 SPRING CHECK VALVE 1000 PSI,CRACKING PRESSURE:1 BAR,METAL SEAT

Spring Check Valve with Viton Seat Part Number Reference

Impa Code	Part No	Description
-	VL-S-VC-G-VI-1000-04	1/4"BSPP SS316 SPRING CHECK VALVE 1000 PSI,CRACKING PRESSURE:1 BAR,VITON SEAT
-	VL-S-VC-G-VI-1000-06	3/8"BSPP SS316 SPRING CHECK VALVE 1000 PSI,CRACKING PRESSURE:1 BAR,VITON SEAT
-	VL-S-VC-G-VI-1000-08	1/2"BSPP SS316 SPRING CHECK VALVE 1000 PSI,CRACKING PRESSURE:1 BAR,VITON SEAT
-	VL-S-VC-G-VI-1000-12	3/4"BSPP SS316 SPRING CHECK VALVE 1000 PSI,CRACKING PRESSURE:1 BAR,VITON SEAT
-	VL-S-VC-G-VI-1000-16	1"BSPP SS316 SPRING CHECK VALVE 1000 PSI,CRACKING PRESSURE:1 BAR,VITON SEAT
-	VL-S-VC-G-VI-1000-20	1 1/4"BSPP SS316 SPRING CHECK VALVE 1000 PSI,CRACKING PRESSURE:1 BAR,VITON SEAT
-	VL-S-VC-G-VI-1000-24	1 1/2"BSPP SS316 SPRING CHECK VALVE 1000 PSI,CRACKING PRESSURE:1 BAR,VITON SEAT
-	VL-S-VC-G-VI-1000-32	2"BSPP SS316 SPRING CHECK VALVE 1000 PSI,CRACKING PRESSURE:1 BAR,VITON SEAT
-	VL-S-VC-N-VI-1000-04	1/4"NPT SS316 SPRING CHECK VALVE 1000 PSI,CRACKING PRESSURE:1 BAR,VITON SEAT
-	VL-S-VC-N-VI-1000-06	3/8"NPT SS316 SPRING CHECK VALVE 1000 PSI,CRACKING PRESSURE:1 BAR,VITON SEAT
-	VL-S-VC-N-VI-1000-08	1/2"NPT SS316 SPRING CHECK VALVE 1000 PSI,CRACKING PRESSURE:1 BAR,VITON SEAT
-	VL-S-VC-N-VI-1000-12	3/4"NPT SS316 SPRING CHECK VALVE 1000 PSI,CRACKING PRESSURE:1 BAR,VITON SEAT
-	VL-S-VC-N-VI-1000-16	1"NPT SS316 SPRING CHECK VALVE 1000 PSI,CRACKING PRESSURE:1 BAR,VITON SEAT
-	VL-S-VC-N-VI-1000-20	1 1/4"NPT SS316 SPRING CHECK VALVE 1000 PSI,CRACKING PRESSURE:1 BAR,VITON SEAT
-	VL-S-VC-N-VI-1000-24	1 1/2"NPT SS316 SPRING CHECK VALVE 1000 PSI,CRACKING PRESSURE:1 BAR,VITON SEAT
-	VL-S-VC-N-VI-1000-32	2"NPT SS316 SPRING CHECK VALVE 1000 PSI,CRACKING PRESSURE:1 BAR,VITON SEAT

Chuan Kok Hardware & Machinery Pte Ltd

Address : 1783 Geylang Bahru, #01-02, Singapore 339708
Telephone Number : +65 6294 2566
Email Address : info@chuankok.com
Website : www.chuankok.com
Business Registration Number : 198201577Z
Country of Registration : Singapore

Conditions of Use of Catalogue:

The information in the catalogue are not binding and in order to improve distribution, Chuan Kok Hardware & Machinery Pte Ltd reserves the right to make any change including size and pressure ratings considered necessary at any time and without prior notice. According to the copyright and the civil law, any reproduction (also partial) of figures and texts of this catalogue by means of electronic, mechanical, photocopies, microfilms, recordings or other is forbidden without Chuan Kok Hardware & Machinery Pte Ltd's authorization.
Catalogue Version: 2021

